



Cedar Avenue, Kimblesworth, DH2 3QF
2 Bed - House - Semi-Detached
£100,000

ROBINSONS
SALES • LETTINGS • AUCTIONS • SURVEYS

Cedar Avenue Kimbleworth, DH2 3QF

* NO CHAIN * MUCH IMPROVED* EXCELLENT POSITION WITH GOOD TRANSPORT LINKS
* TWO LARGE BEDROOMS * UTILITY ROOM*

Situated in the traditionally sought after village of Kimbleworth, this two bedroom semi detached house is offered to the market with no onward chain and vacant possession. The property has been much improved, making it an ideal choice for a range of buyers including first time buyers or a small family.

The internal layout includes a spacious, light lounge and dining area with French doors opening onto the rear garden, an attractive kitchen, and the added benefit of a practical utility room. To the first floor are two generously sized bedrooms and a well presented white suite family bathroom.

Externally the property enjoys a west facing garden which offers a good degree of privacy, as well as a side entrance with useful storage.

Key features include attractive kitchen and bathroom, combi boiler with gas central heating, recent electric meter, new roof within the last five years, new fence to boundary within the last three years, UPVC double glazing throughout with new front door, cavity wall insulation, and fresh neutral décor throughout.

The location offers easy access to the village cricket ground, football field, and children's play areas, with excellent transport links to Chester le Street, Newcastle, the Arnison Retail Park and Durham City.











GROUND FLOOR

Hallway

Living / Dining Room

17'0" x 12'1" (5.2 x 3.7)

Kitchen

10'9" x 7'10" (3.3 x 2.4)

Utility Room

External Store House

FIRST FLOOR

Landing

Bedroom One

15'1" x 9'10" (4.6 x 3)

Bedroom Two

10'9" x 9'10" (3.3 x 3)

Bathroom

7'10" x 5'6" (2.4 x 1.7)

Agent's Notes

Electricity Supply: Mains

Water Supply: Mains

Sewerage: Mains

Heating: Gas Central Heating

Broadband: Basic 7 Mbps, Superfast 80 Mbps

Mobile Signal/Coverage: Average

Tenure: Freehold

Council Tax: Durham County Council, Band A - Approx. £1,701 p.a

Energy Rating: D



Disclaimer: The preceding details have been sourced from the seller and OnTheMarket.com. Verification and clarification of this information, along with any further details concerning Material Information parts A, B & C, should be sought from a legal representative or appropriate authorities. Robinsons cannot accept liability for any information provided.

Cedar Avenue

Approximate Gross Internal Area
764 sq ft - 71 sq m

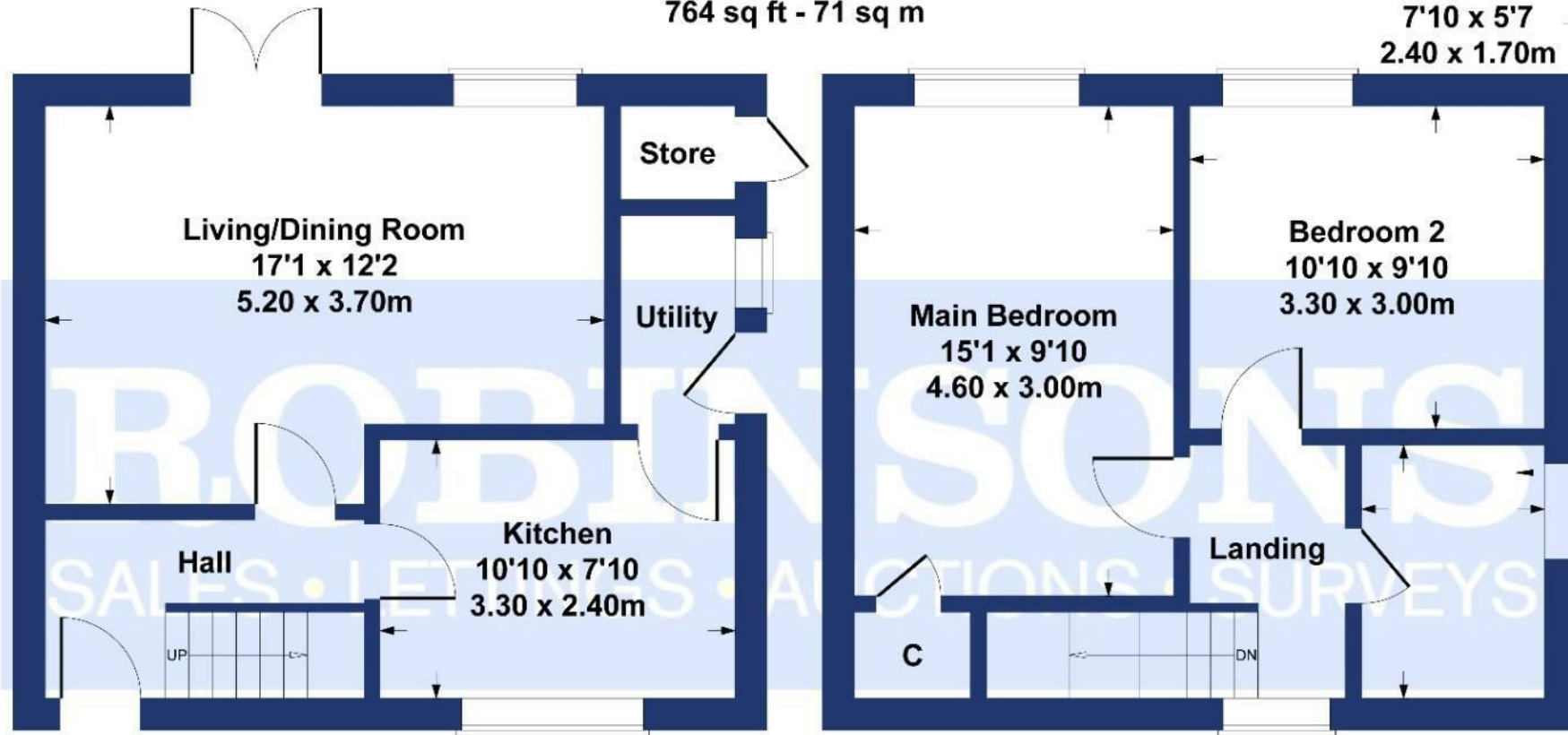

GROUND FLOOR

FIRST FLOOR

SKETCH PLAN FOR ILLUSTRATIVE PURPOSES ONLY

All measurements walls, doors, windows, fittings and appliances, their sizes and locations, are approximate only. They cannot be regarded as being a representation by the seller, nor their agent.

Produced by Potterplans Ltd. 2025

Energy Efficiency Rating		Current	Potential
Very energy efficient - lower running costs			
(92 plus) A			82
(81-91) B			
(69-80) C			
(55-68) D		65	
(39-54) E			
(21-38) F			
(1-20) G			
Not energy efficient - higher running costs			
England & Wales		EU Directive 2002/91/EC	



45 Front Street, Chester Le Street, DH3 3BH
Tel: 0191 387 3000
info@robinsonscsls.co.uk
www.robinsonsestateagents.co.uk

